



**THE
VILLAGE
APARTMENTS**

Located five miles east of downtown Bartlesville. The Village offers a distinctive style of living at an affordable rent. You'll find quality features like brick and vinyl exteriors, pleasant neutral tone interior colors, efficient all-electric utilities. Enjoy our large pond with fountain in a park-like setting with all amenities listed below.

DESIGNED FOR COMFORT AND STYLE

- * Park-like landscaping
- * Swimming pool
- * Basketball Court
- * Stackable washer/dryer hook-ups
- * Dishwasher, Refrigerator, Garbage disposal
- * Range with hood

DESIGNED FOR ENERGY EFFICIENCY

- * High efficiency air conditioning
- * Extra wall and ceiling insulation
- * Insulated windows and doors
- * Interior sealed for air-tightness

DESIGNED FOR PRIVACY & SECURITY

- * Sound-deadening construction
- * Deadblott locks
- * Well-lighted parking areas
- * Fire-resistant materials
- * Smoke alarms

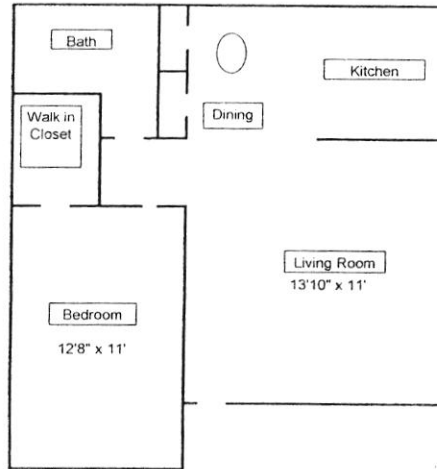

S 1BR 1 Bath 12 months \$450.00
600 Sq. ft. 6 months \$475.00
No dishwasher or w/d hook-ups

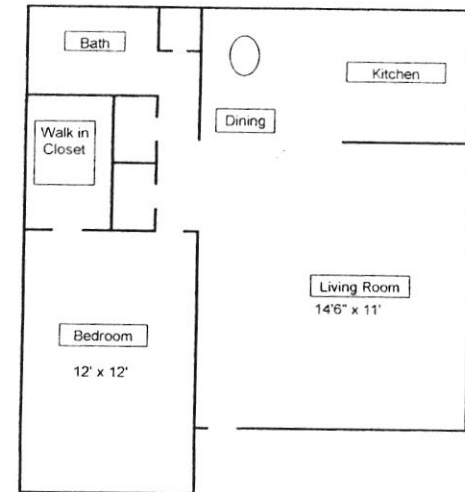

L 1BR 1 Bath 12 months \$480.00
650 Sq. ft. 6 months \$505.00

CLUBHOUSE FEATURES

- * Club room with fireplace for private gatherings
- * Fully equipped kitchen area
- * Game Room with Fireplace
- * Pool Table, Ping Pong Table
- * Exercise Equipment
- * Central Laundry room

A CHOICE OF FOUR FLOOR PLANS:

Deposit \$375.00
Less -75.00 Shampoo
Refundable \$300.00

Resident pays electricity
We pay water/sewer/trash pick-up
No gas/all electric

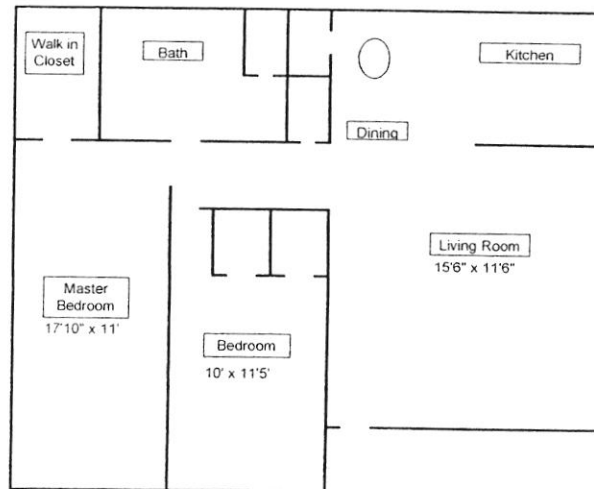

2BR 1 Bath 12 months \$570.00
850 Sq. ft. 6 months \$595.00

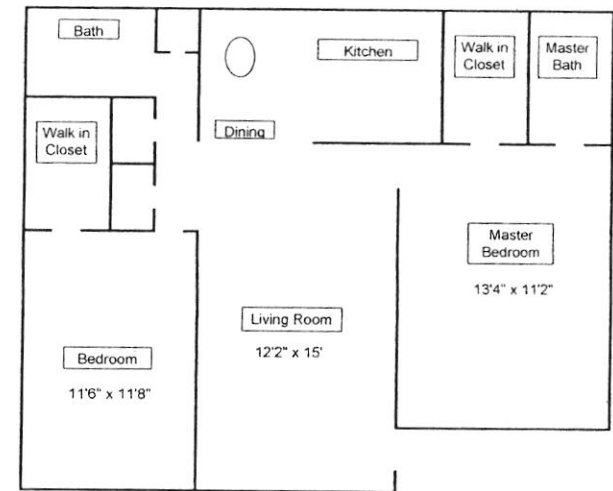

2BR 2 Bath 12 months \$600.00
850 Sq. ft. 6 months \$625.00